



DAILY AIR MONITORING REPORT

Ringwood Mines/Landfill Superfund Site

Ringwood, New Jersey

05/20/22

Page 1 of 1		Rev. No. 1
Submitted By: Emilcott		
Dust Alert Level	100 µg/m ³	
Dust Action Level	150 µg/m ³	
TVOC Alert Level	2 ppm	
TVOC Action Level	4 ppm	

Weather Data Range for Work Day		Wind Direction	ESE		Relative Humidity (%)	65.0 - 100.0		Daily Rain (in)	Station Designation Key: Upwind = (U) Downwind = (D)	
Temp (°F)	54.0 - 72.0		Wind Speed (MPH)	0.6 - 4.4		Barometer (inHg)	29.90 - 30.00			

Peters Mine Pit Area Stations	Daily Avg. Dust Concentration (µg/m ³)	Max 15 Min Dust Concentration (µg/m ³)	Reading in Excess of Action Level	Time of Max Dust Reading	Daily Avg. VOC Concentration (ppm)	Max 15 Min VOC Concentration (ppm)	Reading in Excess of Action Level	Time of Max VOC Reading
P-1 (D)	37.5	45.8	No	9:30	0.0	0.0	No	7:45
P-2 (D)	46.0	59.4	No	11:00	0.0	0.0	No	7:45
P-3 (D)	54.9	67.5	No	12:30	0.0	0.0	No	7:45
P-4 (U)	74.7	87.5	No	12:30	0.0	0.0	No	7:45
P-5 (D)	3.0	3.0	No	9:15	0.0	0.0	No	8:45

O'Connor Disposal Area Stations	Daily Avg. Dust Concentration (µg/m ³)	Max 15 Min Dust Concentration (µg/m ³)	Reading in Excess of Action Level	Time of Max Dust Reading	Daily Avg. VOC Concentration (ppm)	Max 15 Min VOC Concentration (ppm)	Reading in Excess of Action Level	Time of Max VOC Reading
O-1 (D)	23.5	120.9	No	8:00	0.0	0.1	No	9:30
O-2 (D)	59.9	101.2	No	12:45	0.0	0.0	No	7:45
O-3 (D)	62.9	73.9	No	10:30	0.0	0.0	No	7:45
O-4 (D)	26.7	30.2	No	12:00	0.0	0.0	No	7:45
O-5 (D)	73.3	89.6	No	12:15	0.0	0.0	No	8:45

Cannon Mine Pit Area Stations	Daily Avg. Dust Concentration (µg/m ³)	Max 15 Min Dust Concentration (µg/m ³)	Reading in Excess of Action Level	Time of Max Dust Reading	Daily Avg. VOC Concentration (ppm)	Max 15 Min VOC Concentration (ppm)	Reading in Excess of Action Level	Time of Max VOC Reading
C-1 (D)	40.4	52.3	No	9:15	0.0	0.0	No	7:45
C-2 (D)	56.8	67.8	No	9:15	0.0	0.0	No	7:45
C-3 (U)	77.3	800.2	Yes	12:30	0.0	0.0	No	8:00
C-4 (D)	34.6	45.5	No	8:00	0.0	0.0	No	8:00
C-5 (D)	33.1	38.3	No	10:30	0.0	0.0	No	8:15

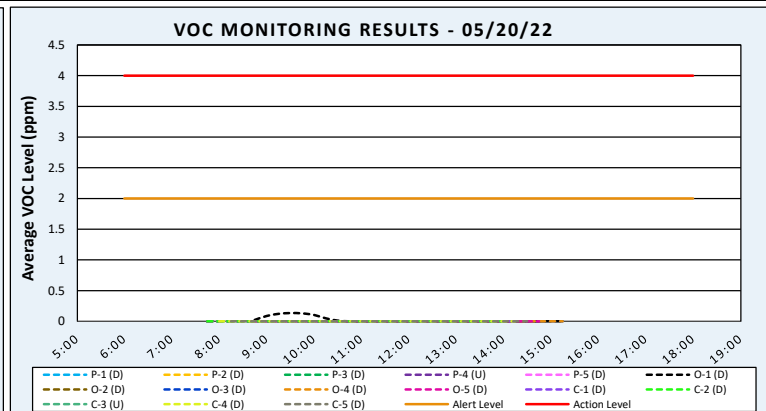
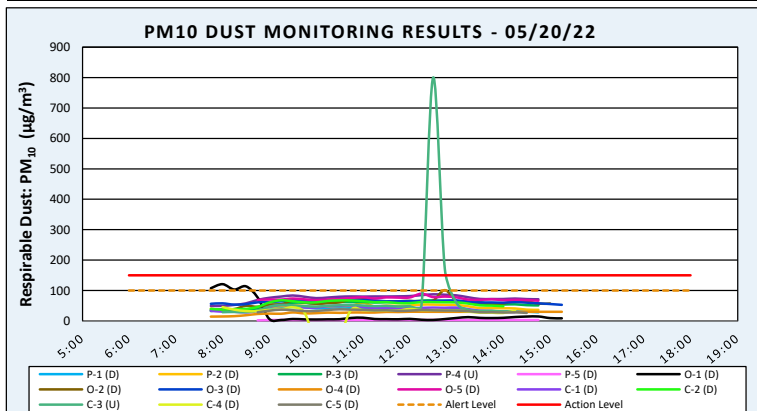

Air Monitoring Notes: The dust action level exceedance at station C-3 at 12:15 was due to build up of humidity in the machine. Winds were blowing from the East South East direction at the time of the action level exceedance. The air monitoring technician confirmed reading to be false by using the sidepack. The dust track was zeroed with a zero filter and readings returned to below action levels. The dust alert level exceedance at O-1 at 8:00 was due to build up of humidity in the machine and the sidepack was used to confirmed that the reading was false. The dust track was zeroed with zero filter and readings returned to below alert levels. The dust alert level exceedance O-2 at 12:45 was due to build up of humidity in the machine and a side pack was used to confirmed that reading was false. The dust track was zeroed filter and readings returned to below alert level exceedance

Weather Notes: Sunny



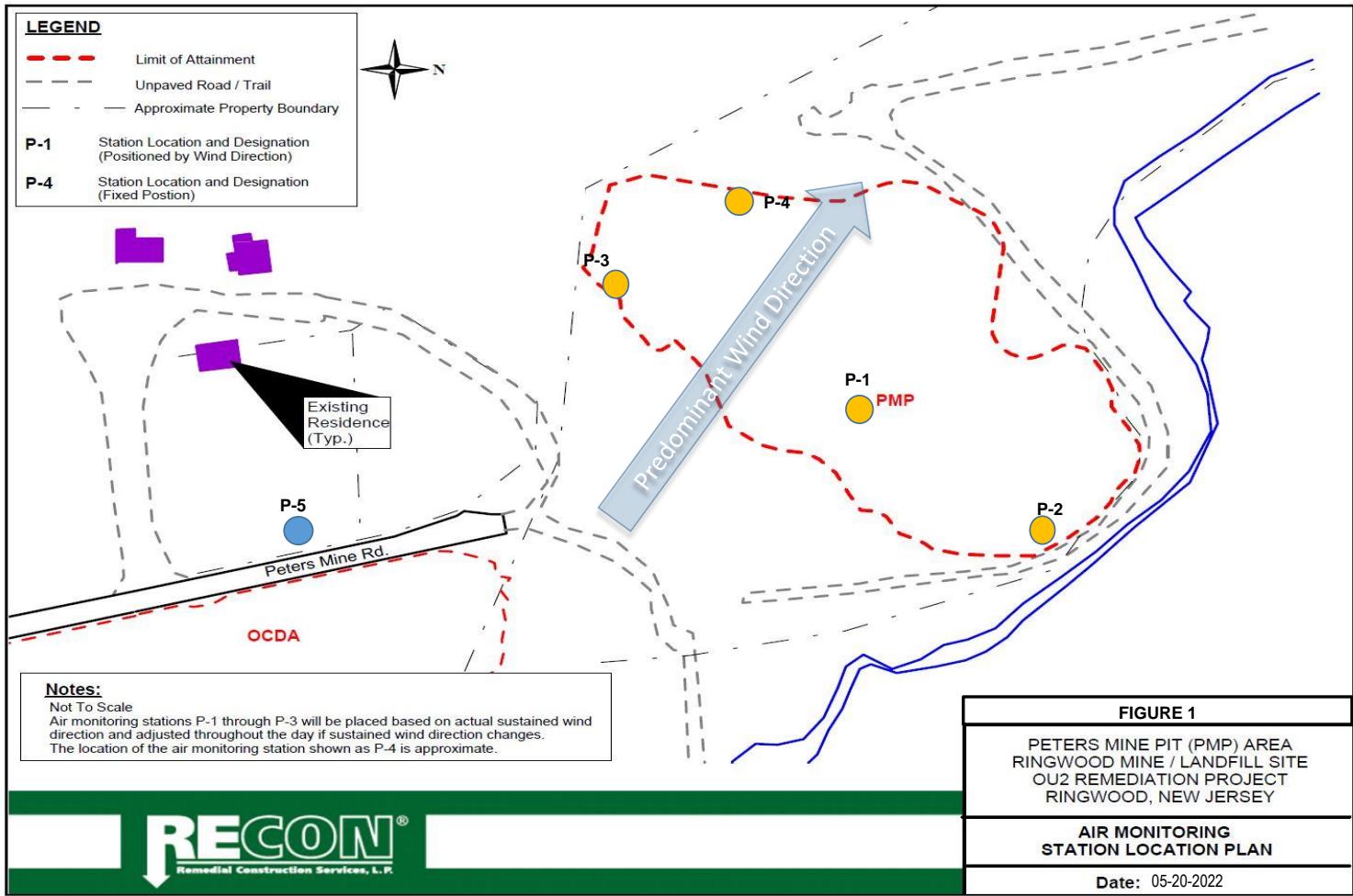

LEGEND

	Limit of Attainment
	Unpaved Road / Trail
	Approximate Property Boundary
P-1	Station Location and Designation (Positioned by Wind Direction)
P-4	Station Location and Designation (Fixed Position)

Notes:
 Not To Scale
 Air monitoring stations P-1 through P-3 will be placed based on actual sustained wind direction and adjusted throughout the day if sustained wind direction changes.
 The location of the air monitoring station shown as P-4 is approximate.

FIGURE 1
PETERS MINE PIT (PMP) AREA RINGWOOD MINE / LANDFILL SITE O2 REMEDIATION PROJECT RINGWOOD, NEW JERSEY
AIR MONITORING STATION LOCATION PLAN
Date: 05-20-2022



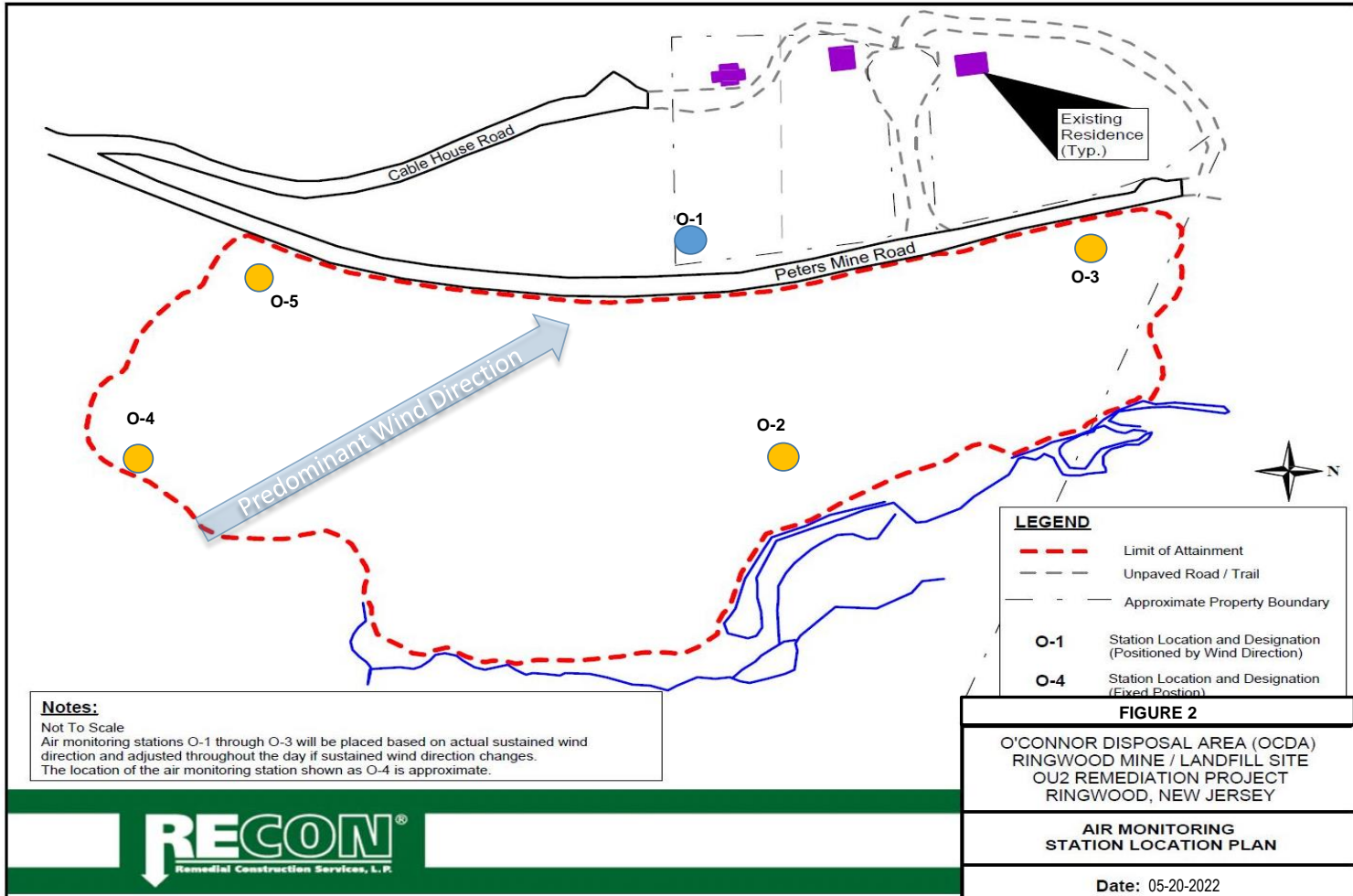

Notes:
 Not To Scale
 Air monitoring stations O-1 through O-3 will be placed based on actual sustained wind direction and adjusted throughout the day if sustained wind direction changes.
 The location of the air monitoring station shown as O-4 is approximate.

LEGEND	
	Limit of Attainment
	Unpaved Road / Trail
	Approximate Property Boundary
	Station Location and Designation (Positioned by Wind Direction)
	Station Location and Designation (Fixed Position)

FIGURE 2
 O'CONNOR DISPOSAL AREA (OCDA)
 RINGWOOD MINE / LANDFILL SITE
 O₂ REMEDIATION PROJECT
 RINGWOOD, NEW JERSEY

**AIR MONITORING
 STATION LOCATION PLAN**

Date: 05-20-2022



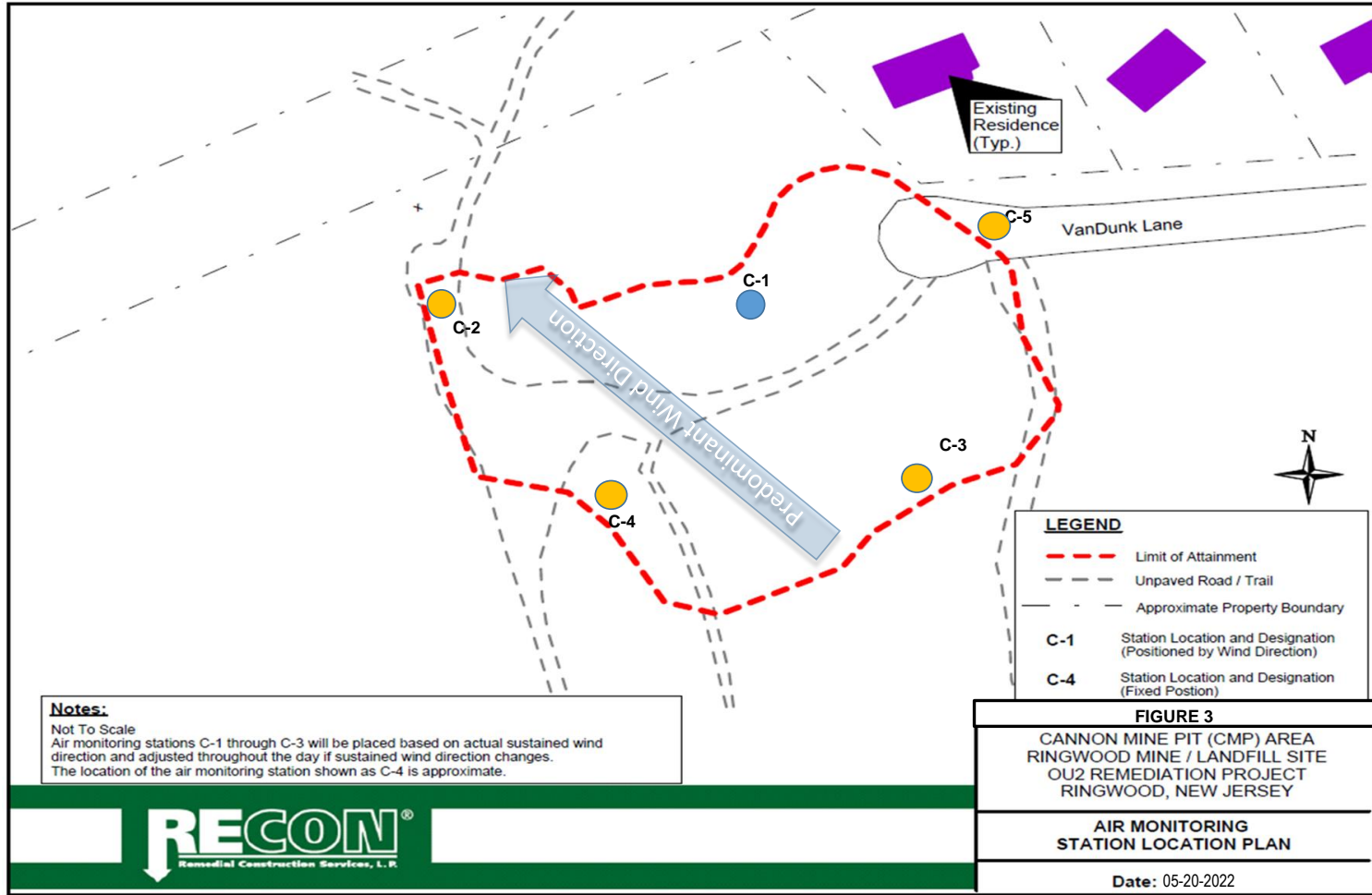

Notes:
 Not To Scale
 Air monitoring stations C-1 through C-3 will be placed based on actual sustained wind direction and adjusted throughout the day if sustained wind direction changes.
 The location of the air monitoring station shown as C-4 is approximate.

LEGEND	
	Limit of Attainment
	Unpaved Road / Trail
	Approximate Property Boundary
	C-1 Station Location and Designation (Positioned by Wind Direction)
	C-4 Station Location and Designation (Fixed Position)

FIGURE 3
 CANNON MINE PIT (CMP) AREA
 RINGWOOD MINE / LANDFILL SITE
 OU2 REMEDIATION PROJECT
 RINGWOOD, NEW JERSEY

**AIR MONITORING
 STATION LOCATION PLAN**

Date: 05-20-2022

